

Installation Tips

Product:

Parts List (parts available with kit only and not available separately)

ITEM	PART NAME	DESCRIPTION	QTY
A	Front left fender flare	CNC cut-out made of 1/8" thick high density polyethylene	1
B	Front right fender flare	CNC cut-out made of 1/8" thick high density polyethylene	1
C	Rear left fender flare	CNC cut-out made of 1/8" thick high density polyethylene	1
D	Rear right fender flare	CNC cut-out made of 1/8" thick high density polyethylene	1
INSTRUCTION BAG	E	Mounting hardware Includes: 42 phillips truss head screws SS M6 x 24, 42 washers SS M6x 25 and 32 flanged locknut M6	1

1. Front left fender flare installation

- a) Remove the OEM screws and nuts from the front lateral panel as shown below by the arrow (6 screws and 1 nuts).

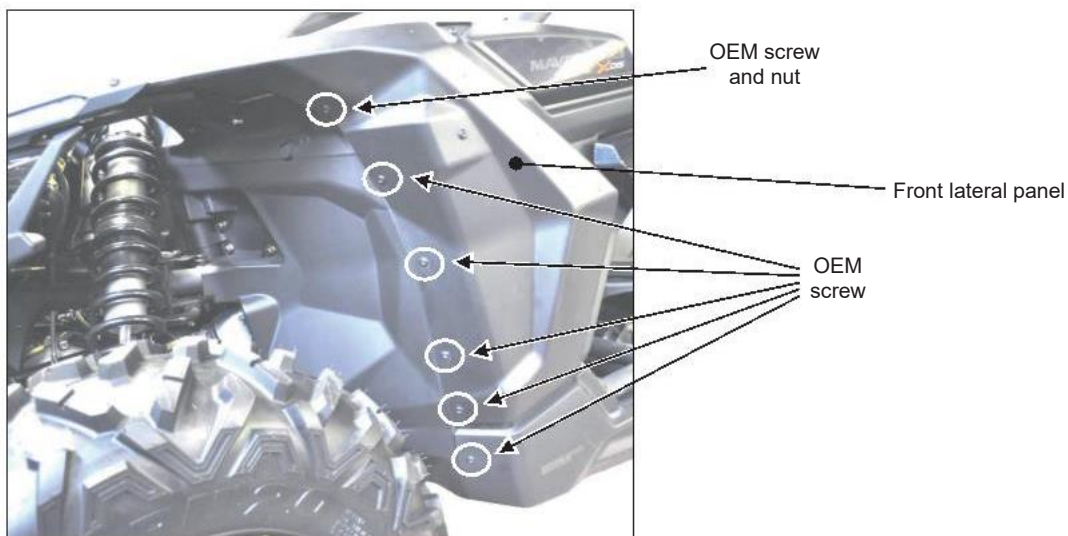

- b) Install the front left fender flare (Item A) to the vehicle front left lateral panel using supplied hardware as shown below.

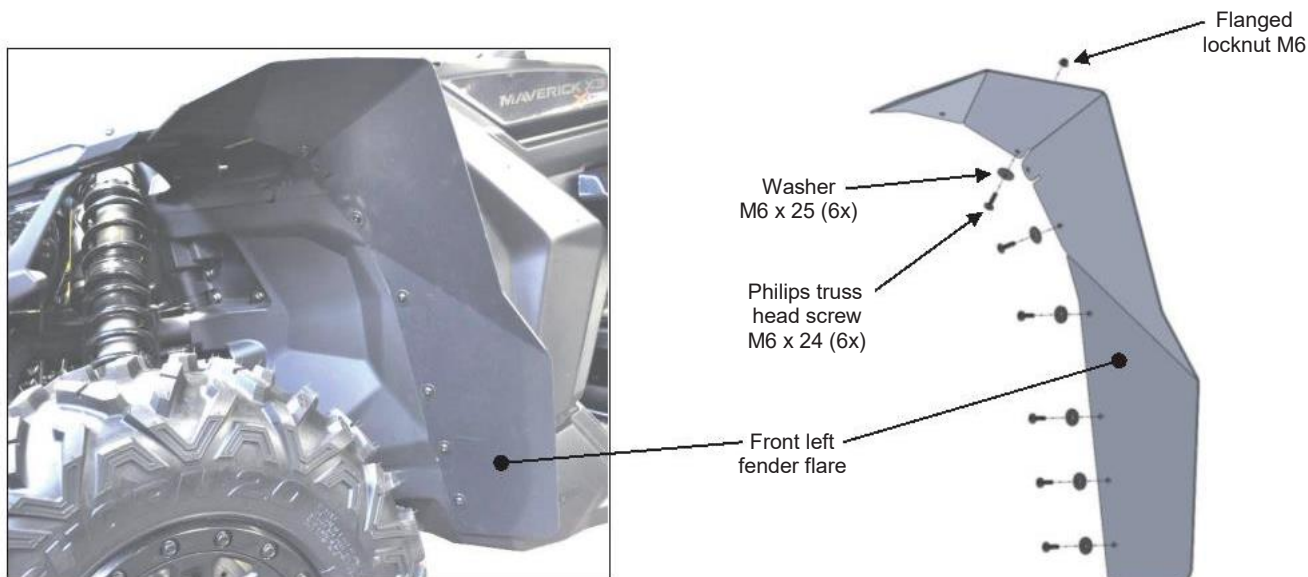

- c) Ensure that the front left fender flare is in proper position.
As reference, the fender flare edge should be aligned perfectly with the lateral panel edge.

Use the fender flare mounting holes as guide and drill two ¼ inch diameter holes through the front left lateral panel and attach with supplied hardware as shown below.

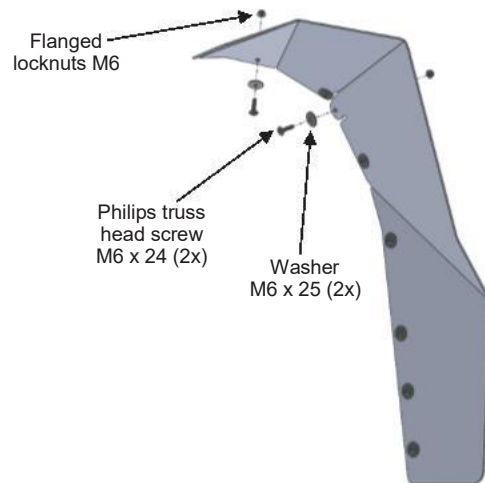
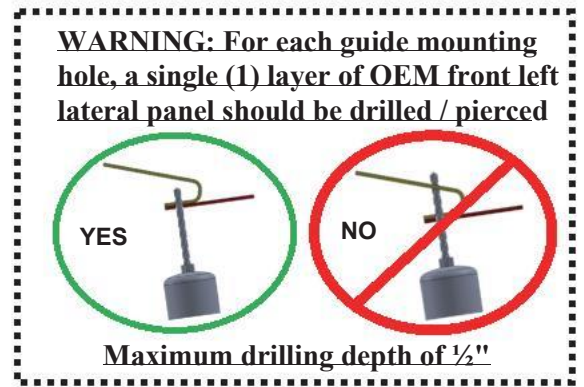

- d) Repeat steps a) to c) for the front right fender flare (Item B).

2. Rear left fender flare installation

- e) Temporarily remove the OEM screw that secure the rear fender deflector to the tail light housing as shown below by the arrow.

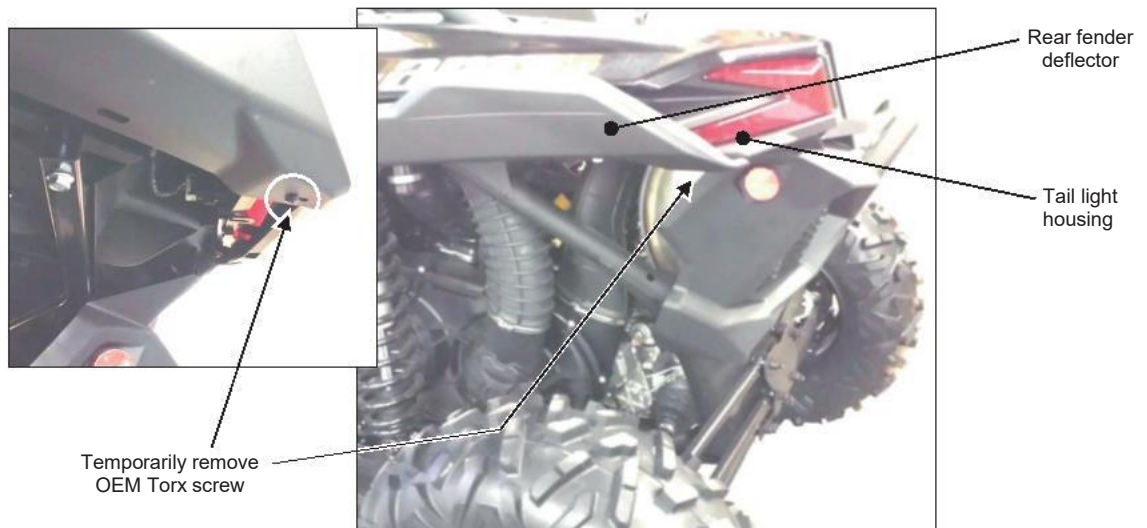

IMPORTANT NOTICES

Over-tightening any and/or all screws will cause cracks around mounting holes which is not covered by any warranty.

- f) Install the rear left fender flare (Item C) to the rear fender deflector using the OEM torx screw removed in previous step.

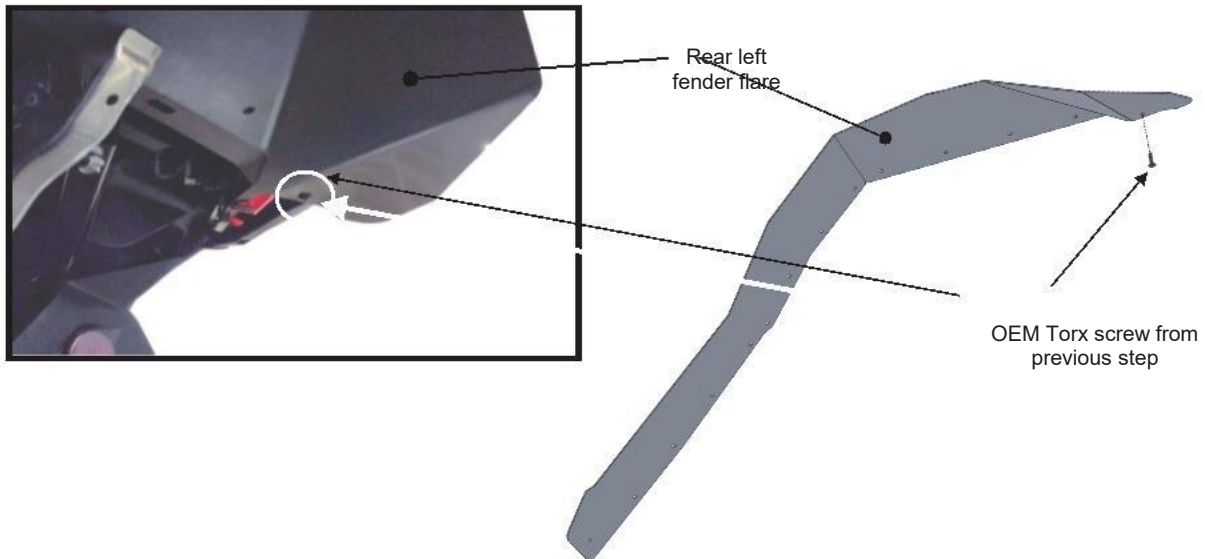

- g) Temporarily secure the remaining section of the fender flare to the vehicle using spring clamps or any other clamping tools as shown below.
As reference, the edge of the fender flare lower section should be aligned perfectly with the OEM fender deflector edge.



- h) Ensure that the rear left fender flare is in proper position and use the fender flare mounting holes as guide to drill 1/4 inch diameter holes through the rear fender deflector.
WARNING: For each hole, a single (1) layer of OEM rear fender deflector should be drilled / pierced.
 Attach with supplied hardware as shown below.



Rear fender deflector

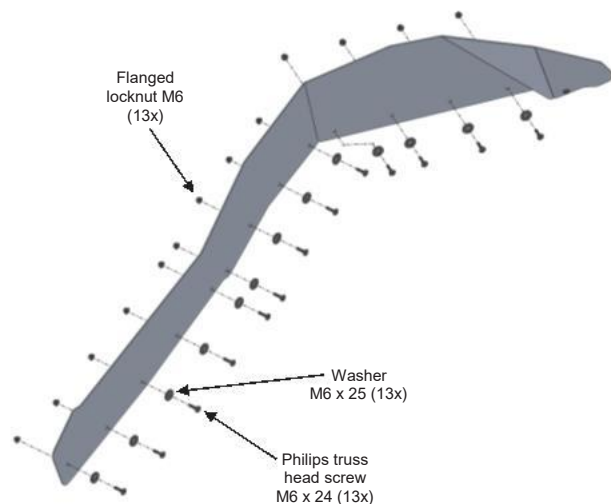

- i) Repeat steps e) to h) for the rear right fender flare (Item D).

3. Maintenance and Care

Tighten all hardware after first use and periodically thereafter.